

C1

C2

C1

- 1@ 5'-4 3/4" 45-45
- 1@ 3'-10 1/2" 45-90
- 1@ 3'-7 1/8" 45-90
- 1@ 2'-9 3/4" 45-90
- 1@ 1'-9 7/8" 45-90
- 4@ 0'-10 1/2" 90-90
- 1@ 0'-10 1/2" 45-90
- 1@ 0'-10" 45-90
- 1@ 0'-9 7/8" 45-90

C2

- 1@ 5'-6 3/4" 90-90
- 1@ 3'-10 1/4" 90-45
- 1@ 3'-8 1/8" 45-90
- 1@ 2'-10 1/4" 90-45
- 1@ 1'-10 1/4" 90-45
- 5@ 0'-10 1/2" 90-90
- 2@ 0'-10 1/4" 45-90

C3

- 1@ 7'-7 1/4" 90-90
- 2@ 4'-5 1/8" 2-2
- 2@ 2'-9 5/8" 2-90
- 1@ 1'-10 3/8" 2-2
- 1@ 1'-9 5/8" 2-2
- 2@ 1'-9" 2-2
- 1@ 1'-8 1/4" 2-2
- 4@ 0'-10 1/2" 90-90
- 1@ 0'-8 1/8" 90-90
- 1@ 0'-7 7/8" 90-2
- 1@ 0'-7 1/2" 90-2
- 1@ 0'-5 7/8" 90-2
- 1@ 0'-5 3/4" 90-2
- 1@ 0'-5 1/2" 90-2
- 1@ 0'-5 3/8" 90-2

C4

- 2@ 3'-8 7/8"
- 2@ 1'-8 3/4"
- 3@ 1'-7 1/4"
- 1@ 0'-11 1/8"
- 3@ 0'-10 1/2"

C4

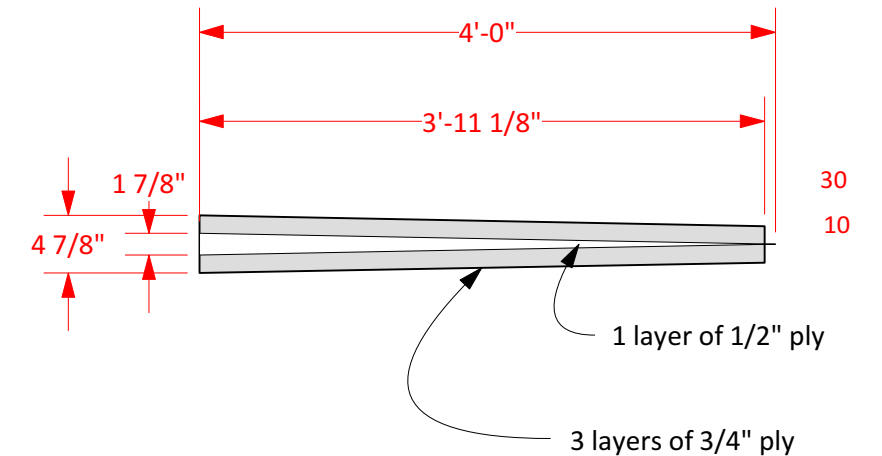
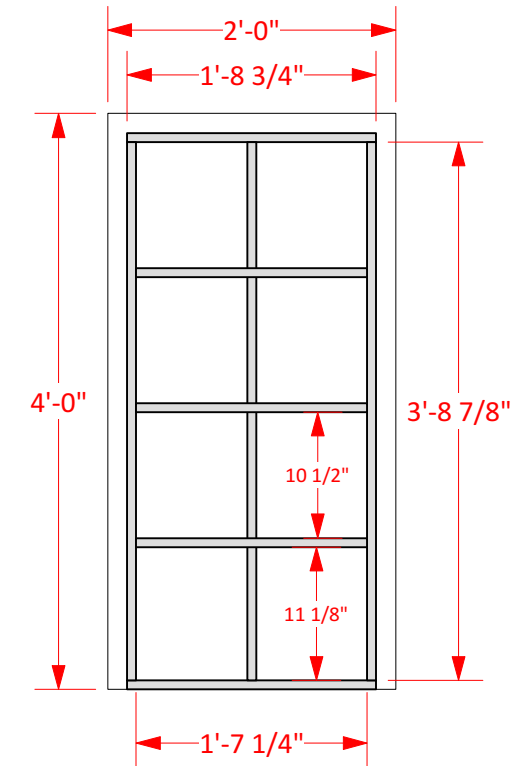

	Catwalk Deck Framing	
	Drawn by: Tom Hackman	Scene Designer: Owen Collins
	PRISCILLA Queen of the Desert	
	Scale: 3/4"=1'-0"	Date: 11 July 18

C4